

Installation Guide Halo Illuminated Mirror

by

 Clearlight Designs®



Installation Instructions

Failure to follow installation instructions could result in serious injury, or damage to property.

Failure to follow installation instructions will void warranty.

Please read these instructions carefully before installation to make sure you have all you need, and to understand what you will be doing during all phases of the handling, installation, removal, operation and maintenance of this product. Failure to comply with these precautions violates safety standards of design, manufacture and intended use of the product.

Clearlight Designs assumes no liability for customer's failure to comply with these requirements.

Installation must only be carried out by a licensed electrician or builder according to local authority regulations.

All electrical works must only be undertaken after disconnection of power by removing fuses or turning off circuit breaker, to ensure all pole isolation of the electrical supply.

IMPORTANT!

Installation must only be carried out by a licensed electrician or builder according to local authority regulations.

**Do not remove protective film or plastic corners until your mirror is installed
Move mirrors SLOWLY. Plan what you are doing.**

Handling Tips

- Always place the mirror on a soft surface e.g. carpet or folded towels. The edge of the mirror will almost certainly chip if placed on a stone or tiles or hard surface.
- Do not touch the frosted glass strips on the back of the mirror. You may end up with the extra task of cleaning off your fingerprints.
- Mirrors are heavy and fragile. Always lift with two people to share the load. Move slowly and carefully, plan and discuss what you are going to do.

Before fitting the mounting structure to the wall or wiring for power connection:

You will need to know the location of:

- the wall studs
- water pipes
- electrical cables

Consult your plans and have a licensed electrician install electrical requirements for your mirror in accordance with this installation guide.

Electrical installation

A light switch to operate the mirror should be installed, on the wall or other convenient location, by a licensed electrician. If a de-mister is fitted to the mirror it can be operated by the same or different switch.

The switch connects a power outlet for the driver. The driver can be located in the vanity cupboard under the mirror for

easy access, or in the ceiling, or in the wall cavity behind the mirror, etc.

From the driver a low voltage cable will run inside the wall to protrude at the approximate centre of the mirror mounting structure, ready for connection to the LEDs (and de-mister if applicable).

STEP 1 - Fitting the mounting structure to the wall:

The mounting structure will be installed using a minimum of five 8 gauge x 40mm button head screws or other engineering approved fasteners.

Mark out on the wall for screw holes:

- Mark the top centre and top corners of the proposed location of the mirror on the wall
- Mark out the position of the hole for the first mounting screw 120mm down from the top centre point.
- Depending on the type of wall, now drill a pilot hole for mounting screw or larger hole for wall plug or wall anchor
- Screw the mounting structure to the wall through screw hole #1.
- Adjust to level by pivoting on the screw.
- When level, mark out the other 4 screw holes marked with # (see the diagram below)
- Now unscrew the mounting structure and place it aside so you can drill the other 4 holes in the wall to set up for the mounting screws or wall plugs or wall anchors as before.

NOTE: Other holes may be drilled in the backing board if warranted, e.g. to screw chassis through to wall studs.

DO NOT drill extra holes into the aluminium split battens. The split battens are already securely attached to the backing board

- Place the mounting structure back in position on the wall and fix into place with all 5 screws.

STEP 2 - Connecting the mirror lights to power

- The 12volt cable for the LEDs should now be retrieved from the wall through the centre of the mounting structure ready to connect to the cable from the LEDs on the mirror.
- The same applies to 12volt DC cable for demister if demister is fitted to mirror.
- Position mirror on a supporting structure such as a table or vanity cupboard.
NOTE - use padding under the mirror to avoid damage from hard surface. Have someone hold the mirror in place while you connect the cables from the driver to the cables on the mirror. (Also connect the cables from the demister if one is fitted)
- Make sure the wires will not interfere with the split battens when mirror is lifted into position. The cables can be taped out of the way on the mounting structure or preferably inserted back into the wall cavity.

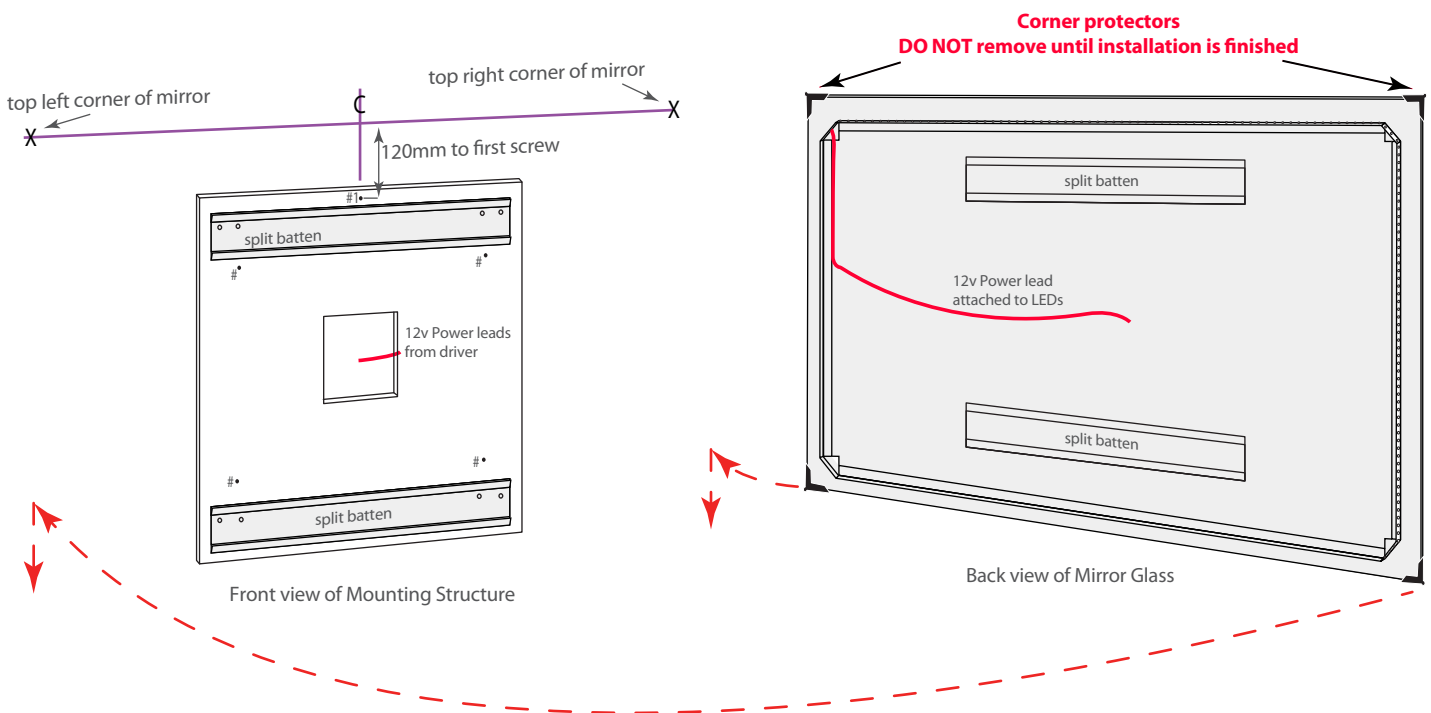

STEP 3 - Hanging the mirror on the mounting structure

- Lift the mirror until the top 2 corners are about 20mm above the corner marks on the wall.
In this position the mirror can be pressed flat on the wall and allowed to slide down into position and engage the split battens.

NOTE It is possible to engage only the top or bottom batten, so at this point do not release the mirror until you are sure both split battens are engaged and the mirror is sitting flat against the wall. If you need to adjust the mirror sideways just lift slightly so the split battens release their grip and the mirror is free to slide.

STEP 4 - Removing the protection

When the mirror is securely in place. Remove corner protectors and carefully peel the protective plastic coating from the front of the mirror glass, starting at the top and slowly peel down.

Care and Cleaning

On the edge of every the mirror there is a thin line of silver that is exposed to the air. Silver will tarnish eventually and the tarnish may spread under the paint. The mirrors we use employ the latest and best paint technology to prevent this. In order to protect your mirror even more we apply an edge sealer. Cleaning the edge of the mirror with commercial cleaners is unnecessary and may eventually damage that edge seal. To clean the mirror edge all you need is a quick wipe down with a soft cloth dampened with distilled water.

DO NOT USE CLEANERS ON THE EDGE OR BACK OF THE MIRROR. Even air born chemicals e.g. toilet flush chemicals, may tarnish your mirror,

When cleaning a mirror simply wipe the glass surface with a few drops of methylated spirits or Isopropyl Alcohol on a clean slightly damp cotton cloth. We have found the Isopropyl Alcohol is the best for cleaning mirrors.

Do not use cleaners containing Ammonia, or bleach, this will void warranty
Some paper towels may leave a smear.

12 volt DC transformer - LED Driver

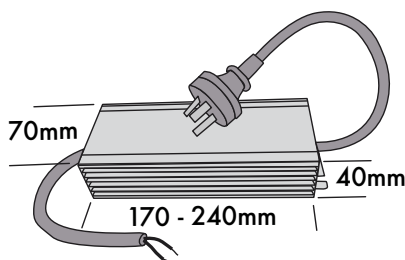

Internal side-view of how the Split battens install works

